

Glue-Line Rip

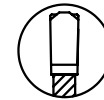

Rip to Dimension

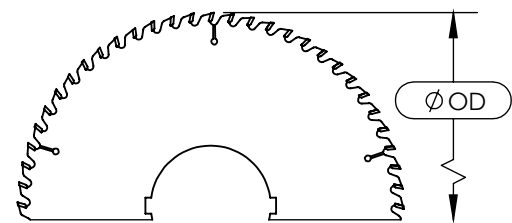

Typical HT (Hub Thickness) 3.00mm

Technical Specifications

Part	Kerf	OD (Outer Diameter)	Z (# of Teeth)	RD (Rim Depth)	RT (Rim Thickness)	Plate Thickness	Timber Thickness		
SPSR-305-036-12-1.70	2.70mm	.106"	12"	z36	12mm	1.70mm	2.00mm	.079"	5/4" max
SPSR-305-036-12-1.90	2.90mm	.114"	12"	z36	12mm	1.90mm	2.00mm	.079"	5/4" max
SPSR-305-036-12-2.20	3.20mm	.126"	12"	z36	12mm	2.20mm	2.50mm	.098"	5/4" max
SPSR-305-036-12-2.50	3.60mm	.142"	12"	z36	12mm	2.50mm	2.80mm	.110"	5/4" max
SPSR-305-048-12-1.70	2.70mm	.106"	12"	z48	12mm	1.70mm	2.00mm	.079"	5/4" max
SPSR-305-036-12-1.90	2.90mm	.114"	12"	z48	12mm	1.90mm	2.00mm	.079"	5/4" max
SPSR-305-036-12-2.20	3.20mm	.126"	12"	z48	12mm	2.20mm	2.50mm	.098"	5/4" max
SPSR-305-036-12-2.50	3.60mm	.142"	12"	z48	12mm	2.50mm	2.80mm	.110"	5/4" max

Relieved Shoulder Rip Saws feature a shallow rim at the OD which provides added clearance around the tip from just below the gullet to the top of the shoulder for cooler cutting and reduced resin build up.

To help us quote the right blade for you, please [contact](#) one of our knowledgeable sales staff and let us know about your application and what goals you are looking to achieve.

Bore Pattern Specs

Machine MFG	Ø Bore	Ø Pinhole	Keyway Specs
Progressive	3.125"	N/A	DKW W: 13.2mm x L: 4.19mm
Progressive	3.750"	N/A	DKW W: 12.7mm x L: 4.19mm

sales@superthinsaws.com